

**Contém**

- A** 1x
- B** 2x
- C** 2x
- D** 4x
- E** 2x
- F** 4x
- G** 4x
- H** 2x
- I** 2x
- J** 4x
- L** 24x
- M** 4x

**1**

1.1

1.2

1m

**2**

2.1

2.2

2.3

**3**

**4**

4.1

1.00M

4.2

28.6

4.3

1m

Aplicação de fibra de vidro  
Aplicación de la malla de fibra de vidrio  
Application du filet de fibre de verre  
Glass fiber mesh application

**5**

5.1

165mm

5.2

165mm

5.3



5.4

8

18

Porta | Door | Porte | Puerta

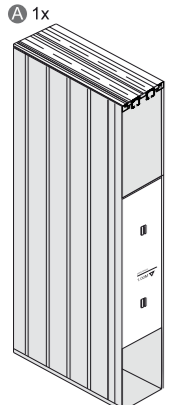
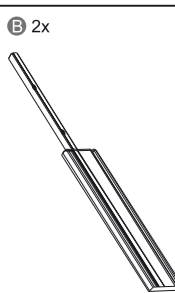
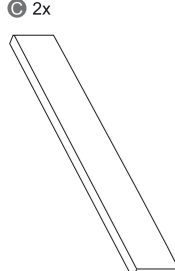
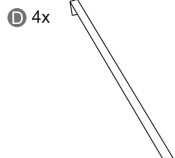
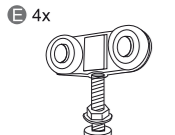
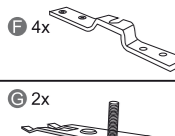
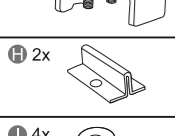
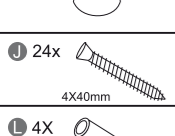
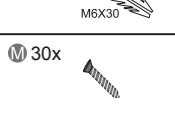
**Contém**

- A** 1x 
- B** 2x 
- C** 2x 
- D** 4x 
- E** 4x 
- F** 4x 
- G** 2x 
- H** 2x 
- I** 4x 
- J** 24x  4x40mm
- L** 4x  M6x30
- M** 30x 

**1**

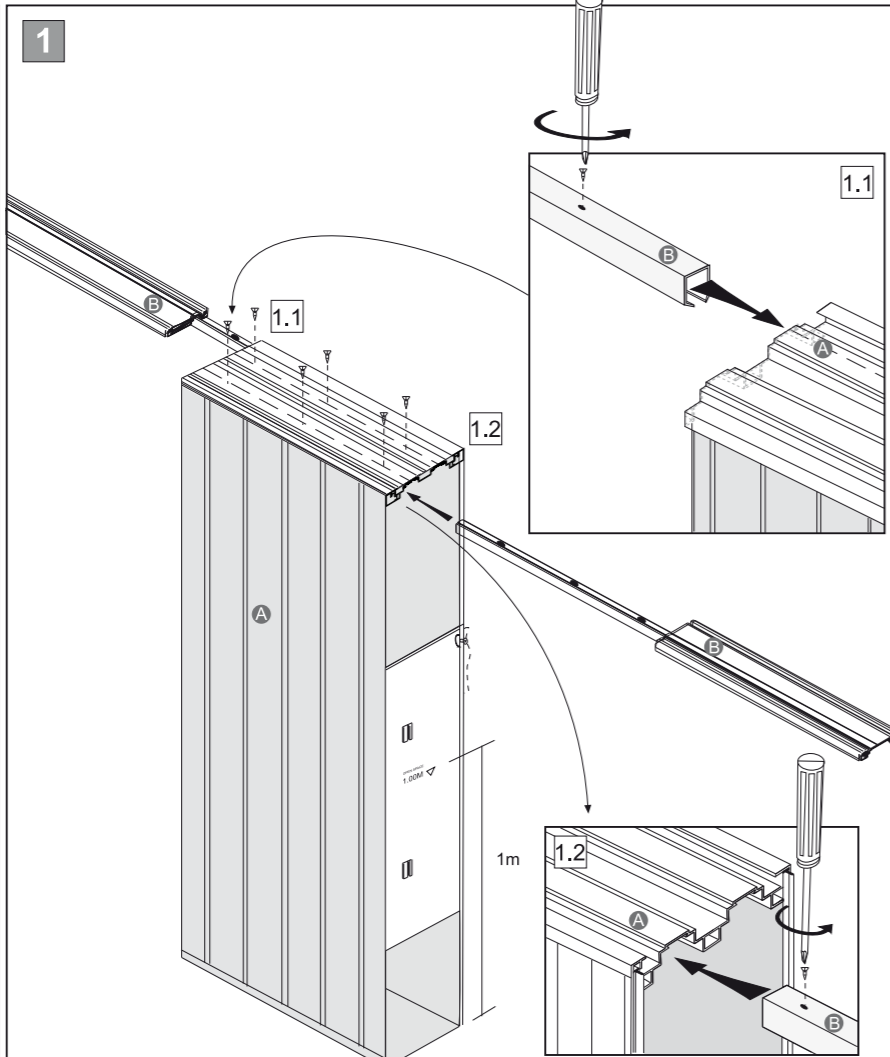

**2**

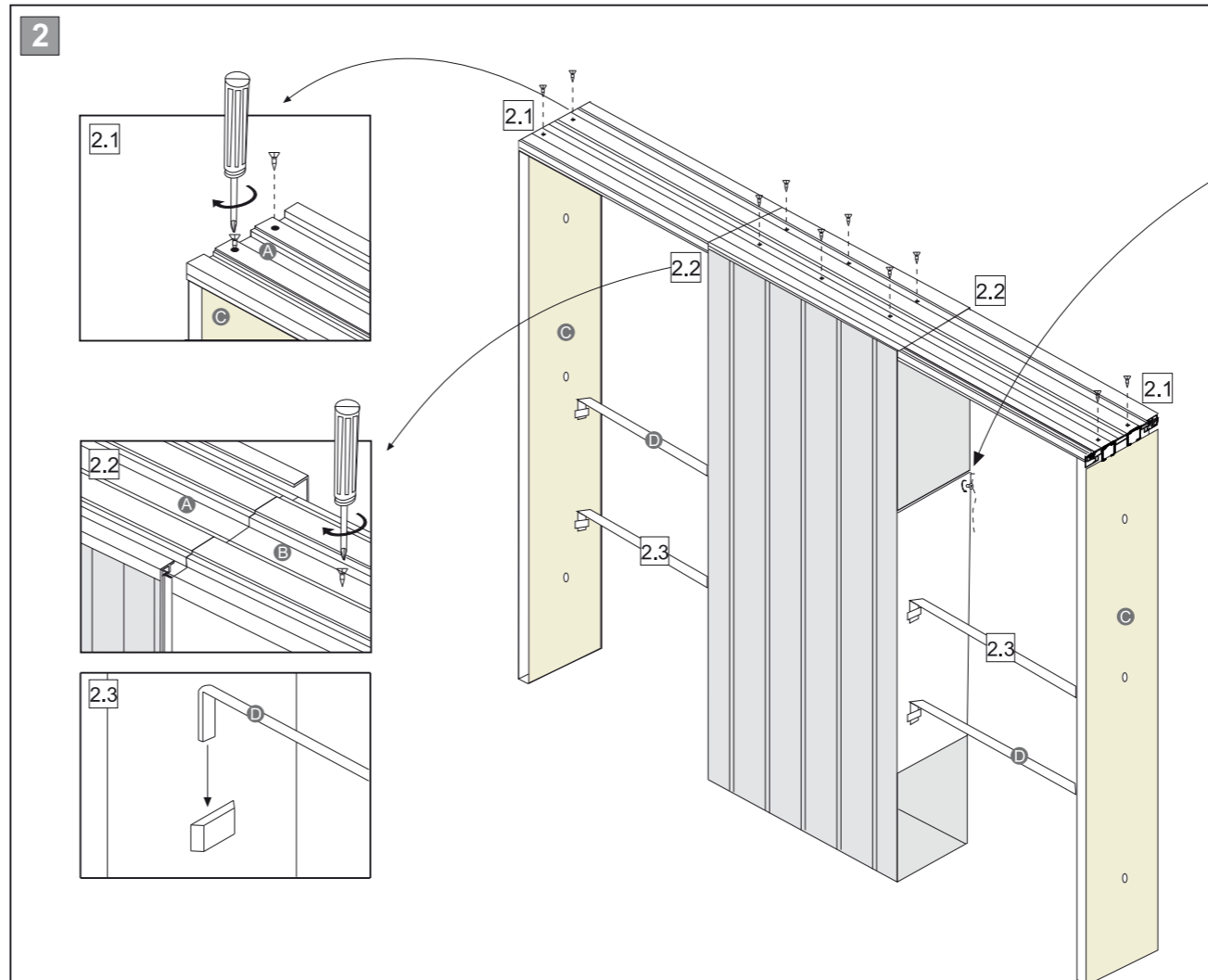

**3**

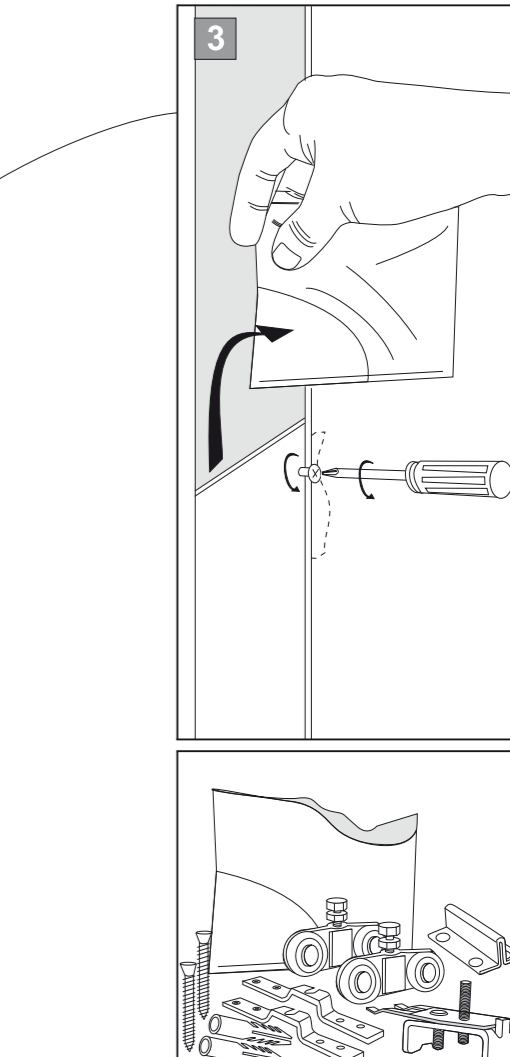

**4**

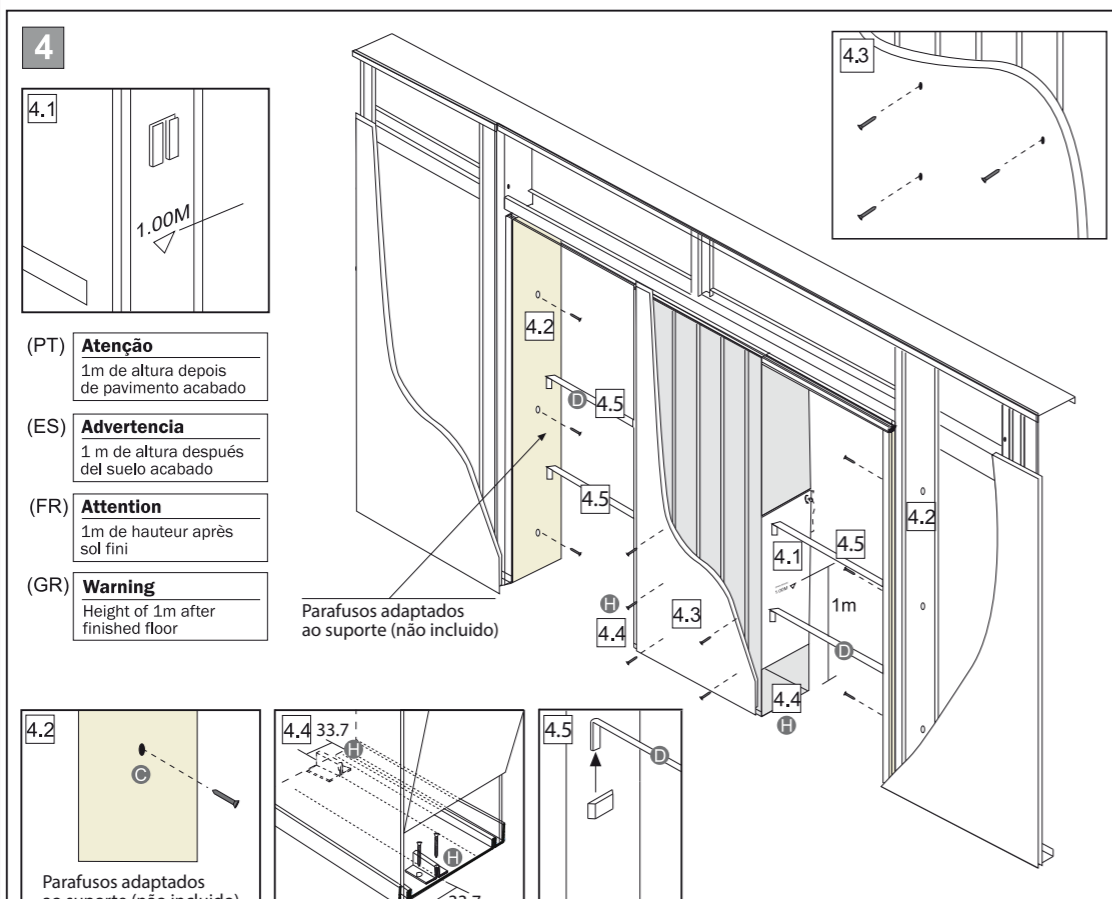

(PT) **Atenção**  
1m de altura depois de pavimento acabado

(ES) **Advertencia**  
1 m de altura después del suelo acabado

(FR) **Attention**  
1m de hauteur après sol fini

(GR) **Warning**  
Height of 1m after finished floor

Parafusos adaptados ao suporte (não incluído)

**5**

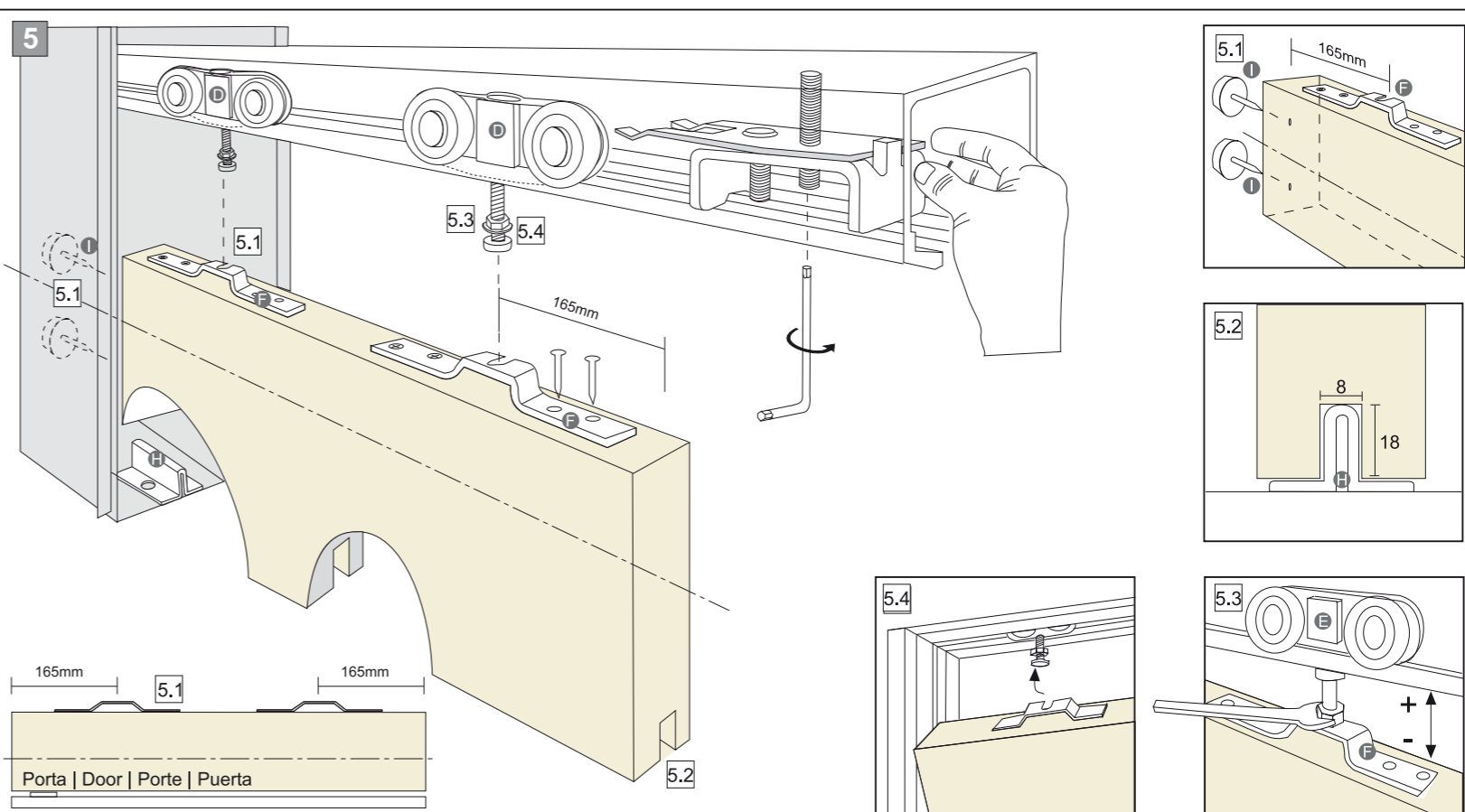

Porta | Door | Porte | Puerta

6

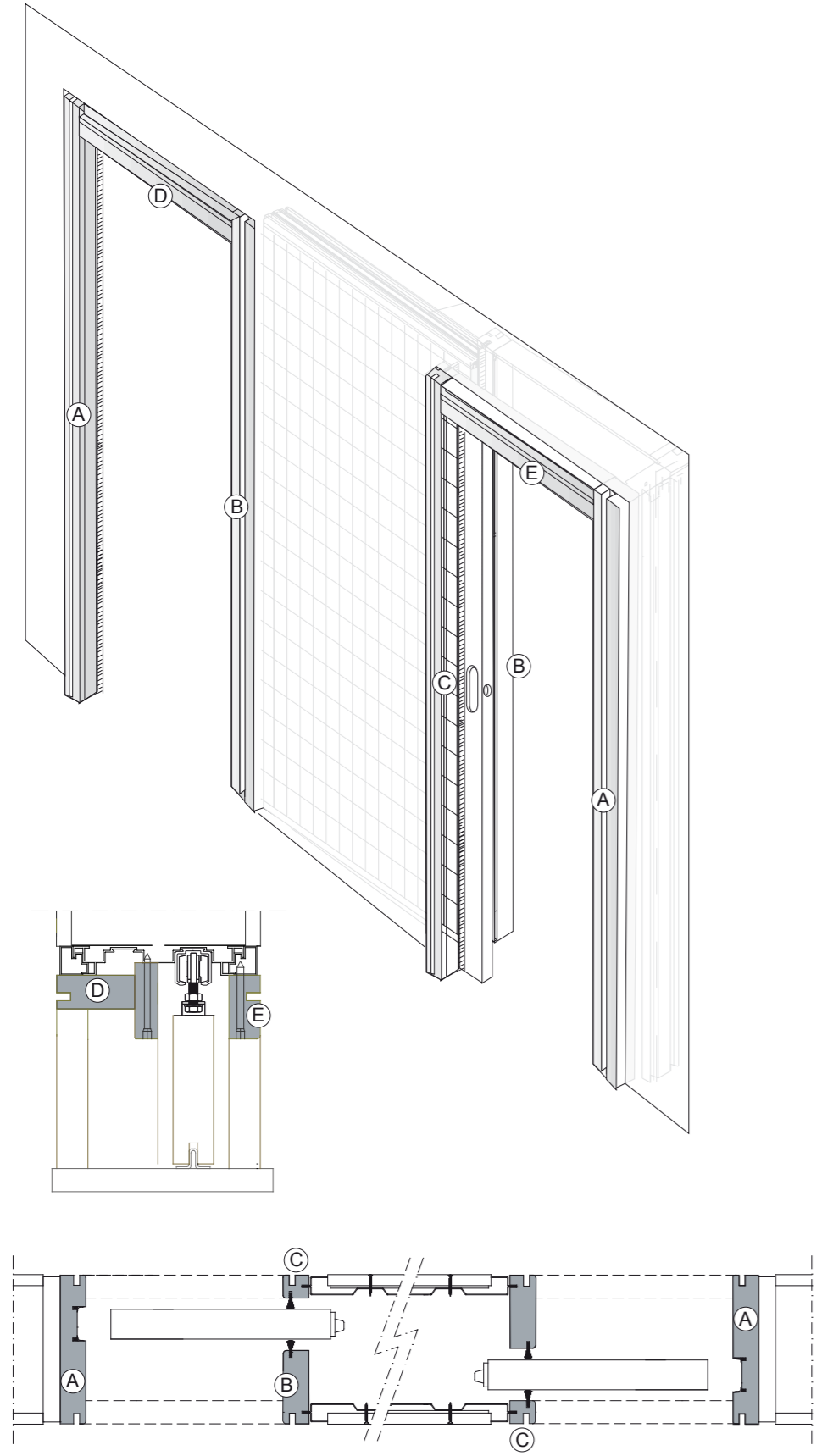

7

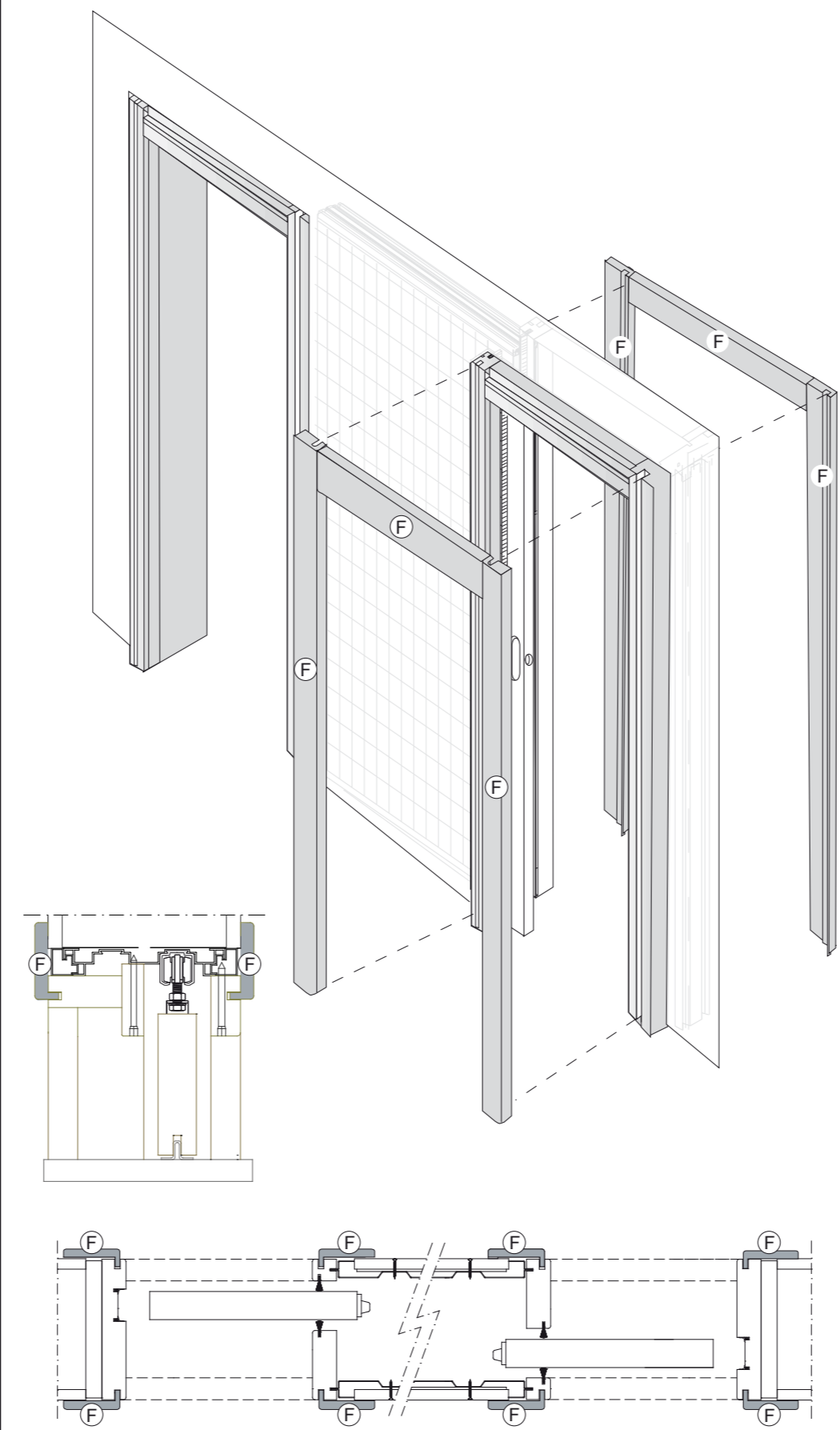

8

